

Private Street  
Public Street

Public and Private Street Plan - Exhibit E

PD ZONING EXHIBIT  
MONARCH CITY  
260.94 ACRES  
JONATHAN PHILLIPS SURVEY, ABSTRACT NO. 719  
CITY OF ALLEN, COLLIN COUNTY, TEXAS  
FEBRUARY 2019

Kimley»Horn

13455 Noel Road, Two Galleria Office Tower, Suite 700, Dallas, Texas 75240		FIRM # 10115500		Tel. No. (972) 770-1300 Fax No. (972) 239-3820	
Scale 1" = 200'	Drawn by DAB	Checked by JAD	Date Sept 2018	Project No. 064527100	Sheet No. 1 OF 1

This product is for informational purposes and may not have been prepared for or be suitable for legal, engineering, or surveying purposes. No warranty is made regarding specific accuracy or completeness. all connections to SRT and US75 must be approved by the TxDOT.

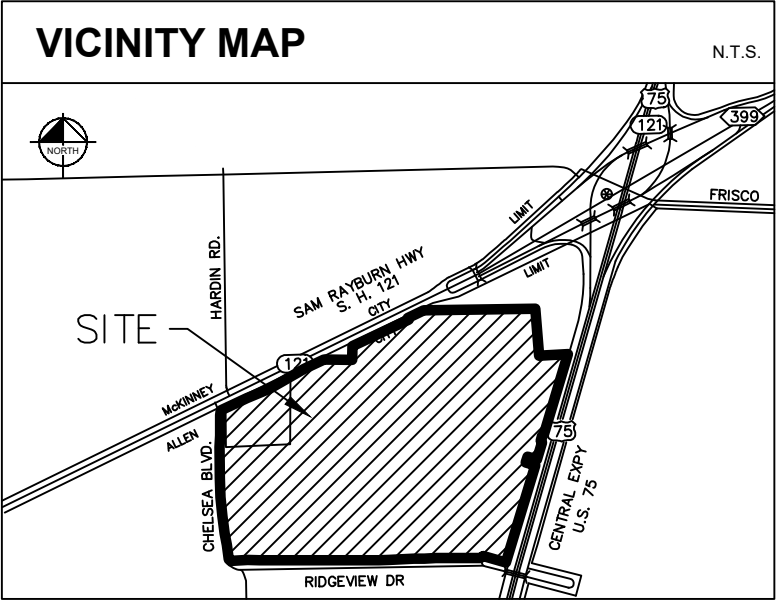
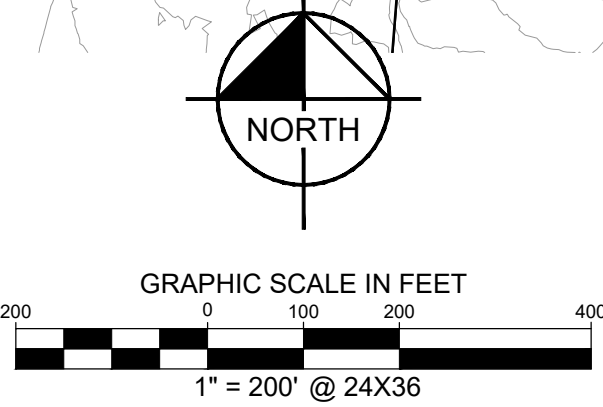

Engineer:  
Kimley-Horn and Associates, Inc.  
13455 Noel Road  
Two Galleria Office Tower, Suite 700  
Dallas, Texas 75240  
PH: (972) 770-1300  
mark.harris@kimley-horn.com

Owner / Applicant  
Allentowne Mall, LLC  
13355 Noel Road, 22nd Floor  
Dallas, Texas 75240  
PH: (972) 741-3021  
mark.bulmash@howardhughes.com

Owner / Applicant  
Allen Economic Development Corporation  
900 W. Bethany Drive, Suite 280  
Allen, Texas 75013  
PH: (972) 721-0262  
dbowman@allenedc.com

D:\GIS\100\ALLEN\TOWNE\TRANSFERS\GATEWAY\PLANNING\2019\203 - CAD FILE\064527100\MONARCH CITY ZONING.DWG PLOTTED BY: GECAL SHAW 12/20/2018 4:50 PM LAST SAVED: 12/20/2018 1:02 PM