

- Character Areas:**
- Urban Main Street
 - Employment
 - Urban Neighborhood
 - Flex Zone
- Streets:**
- A - Primary Street
 - B - Secondary Street
- Parks and Open Space:**
- Required Parks/Open Space
 - Character Area Parks
 - Trails
- Building Frontages:**
- High Building Frontage
 - Medium Building Frontage

Note: A Primary Trailhead will be provided at the Ridgeview Trail near the US 75 intersection. A trail crossing across US 75 will be provided by others.

Regulating Plan - Exhibit B
PD ZONING EXHIBIT
MONARCH CITY
260.94 ACRES
JONATHAN PHILLIPS SURVEY, ABSTRACT NO. 719
CITY OF ALLEN, COLLIN COUNTY, TEXAS
MARCH 2019

Kimley»Horn

13455 Noel Road, Two Galleria Office Tower, Suite 700, Dallas, Texas 75240	FIRM # 10115500	Tel. No. (972) 770-1300	Fax No. (972) 239-3820
Scale 1" = 200'	Drawn by DAB	Checked by JAD	Date Sept 2018
Project No. 064527100	Sheet No. 1 OF 1		

This product is for informational purposes and may not have been prepared for or be suitable for legal, engineering, or surveying purposes. No warranty is made regarding specific accuracy or completeness. all connections to SRT and US75 must be approved by the TxDOT.

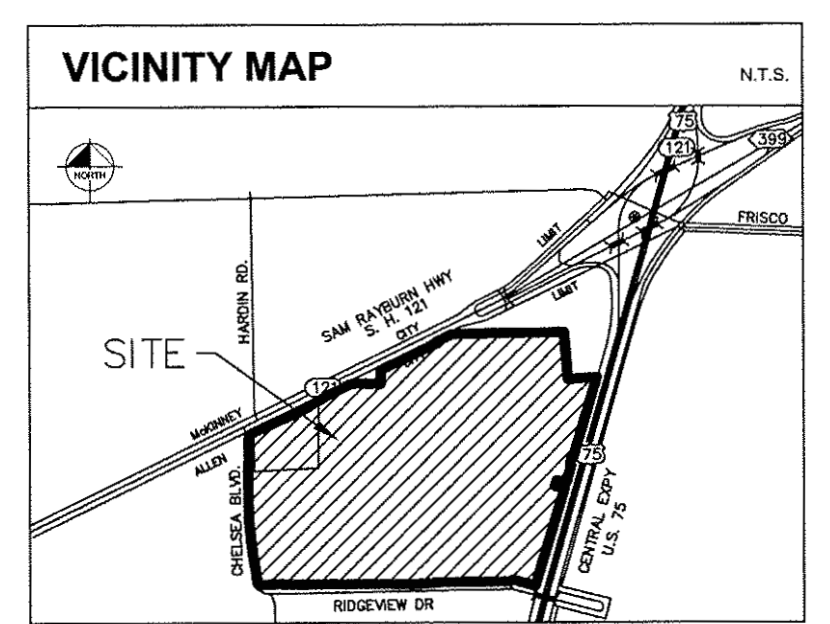
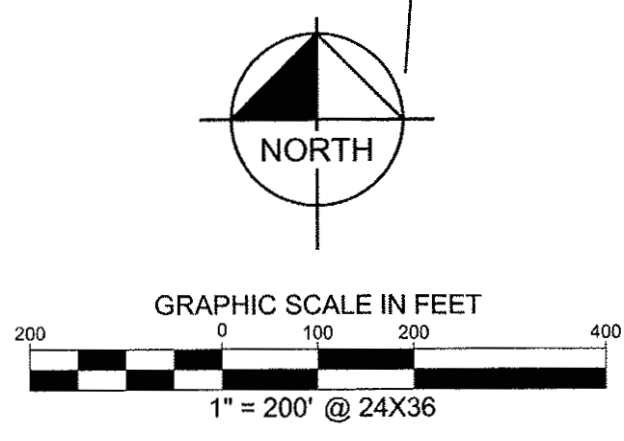

Engineer:
Kimley-Horn and Associates, Inc.
13455 Noel Road
Two Galleria Office Tower, Suite 700
Dallas, Texas 75240
PH. (972) 770-1300
mark.harris@kimley-horn.com

Owner / Applicant
AllenTowne Mall, LLC
13455 Noel Road, 22nd. Floor
Dallas, Texas 75240
PH. (972) 741-3021
mark.buimash@howardhughes.com

Owner / Applicant
Allen Economic Development Corporation
900 W. Bethany Drive, Suite 280
Allen, Texas 75013
PH. (972) 727-0252
dbowman@allenedc.com

BROWN, DANA 12/20/2018 12:29 PM LAST SAVED 12/20/2018 8:45 AM
DWS NAME: K:\ALLEN_SURVEY\064527100-MONARCH CITY ZONING.DWG PLOTTED BY: